

| 6TH FLOOR F.A.R. AREA |     |           |        |        |              |
|-----------------------|-----|-----------|--------|--------|--------------|
| S.N.O.                | NO. | TYPE      | BREATH | LENGTH | AREA IN SQ.M |
| A                     | 1   | RECTANGLE | 19.24  | 58.66  | 1,128.50     |
| B                     | 1   | RECTANGLE | 18.56  | 58.66  | 1,088.55     |
| C                     | 1   | RECTANGLE | 17.29  | 10.78  | 186.32       |
| D                     | 1   | RECTANGLE | 5.35   | 2.87   | 15.38        |
| D1                    | 1   | RECTANGLE | 7.66   | 0.98   | 7.47         |
| D2                    | 1   | TRIANGLE  | 7.66   | 0.95   | 7.28         |
| F                     | 1   | RECTANGLE | 45.65  | 19.32  | 881.88       |
| I                     | 1   | RECTANGLE | 17.78  | 8.07   | 143.48       |
| J                     | 1   | RECTANGLE | 11.00  | 5.10   | 56.10        |
| J1                    | 1   | RECTANGLE | 2.90   | 1.20   | 3.48         |
| K                     | 1   | RECTANGLE | 29.51  | 7.44   | 219.45       |
| L                     | 1   | RECTANGLE | 8.68   | 4.29   | 37.19        |
| M                     | 1   | RECTANGLE | 3.45   | 0.90   | 3.11         |
| R                     | 1   | RECTANGLE | 0.75   | 2.25   | 1.69         |
| V                     | 1   | RECTANGLE | 11.55  | 1.76   | 20.34        |
| W                     | 1   | RECTANGLE | 18.24  | 3.50   | 63.86        |
| W1                    | 1   | RECTANGLE | 9.12   | 1.50   | 13.70        |

| TOTAL ADDITION      |    |           |       |      |         |
|---------------------|----|-----------|-------|------|---------|
|                     |    |           |       |      | 3877.07 |
| SUBTRACTIONS        |    |           |       |      |         |
| 1                   | 1  | RECTANGLE | 3.30  | 6.44 | 21.27   |
| 2                   | 6  | RECTANGLE | 2.50  | 2.15 | 32.25   |
| 2'                  | 1  | RECTANGLE | 2.30  | 3.05 | 7.02    |
| 3                   | 1  | RECTANGLE | 2.50  | 3.10 | 7.75    |
| 4                   | 1  | RECTANGLE | 5.20  | 3.10 | 16.12   |
| 4'                  | 1  | RECTANGLE | 6.09  | 2.95 | 17.98   |
| 5                   | 1  | RECTANGLE | 3.30  | 6.42 | 21.18   |
| 10                  | 1  | RECTANGLE | 2.50  | 1.00 | 2.50    |
| 11                  | 1  | RECTANGLE | 0.85  | 3.05 | 2.59    |
| 12                  | 1  | RECTANGLE | 1.15  | 0.80 | 0.92    |
| 13                  | 1  | RECTANGLE | 1.22  | 0.78 | 0.96    |
| 14                  | 1  | RECTANGLE | 1.60  | 1.23 | 1.96    |
| 15                  | 1  | RECTANGLE | 1.50  | 1.23 | 1.84    |
| 16                  | 1  | RECTANGLE | 2.50  | 2.22 | 5.55    |
| 17                  | 1  | RECTANGLE | 2.68  | 2.93 | 7.85    |
| 17'                 | 1  | RECTANGLE | 0.80  | 0.93 | 0.74    |
| 18                  | 1  | RECTANGLE | 0.60  | 1.80 | 1.08    |
| 19                  | 1  | RECTANGLE | 0.60  | 3.10 | 1.86    |
| 20                  | 1  | RECTANGLE | 3.17  | 0.90 | 2.85    |
| 21                  | 1  | RECTANGLE | 0.55  | 1.10 | 0.61    |
| 22                  | 2  | RECTANGLE | 0.90  | 1.10 | 1.98    |
| 23                  | 2  | RECTANGLE | 1.20  | 0.75 | 1.80    |
| 23A                 | 1  | RECTANGLE | 1.20  | 1.10 | 1.32    |
| 24                  | 3  | RECTANGLE | 1.20  | 0.90 | 3.24    |
| 25                  | 1  | RECTANGLE | 5.15  | 3.45 | 17.79   |
| 25A                 | 1  | RECTANGLE | 2.93  | 1.74 | 5.09    |
| 26                  | 1  | RECTANGLE | 1.56  | 0.43 | 0.67    |
| 26A                 | 1  | TRIANGLE  | 1.56  | 0.19 | 0.30    |
| 27                  | 1  | RECTANGLE | 0.55  | 1.85 | 1.02    |
| 28                  | 1  | RECTANGLE | 2.44  | 2.30 | 5.62    |
| 29                  | 1  | RECTANGLE | 0.95  | 2.30 | 2.19    |
| 30                  | 1  | RECTANGLE | 2.95  | 0.90 | 2.66    |
| 31                  | 1  | RECTANGLE | 2.27  | 0.75 | 1.70    |
| 32                  | 2  | RECTANGLE | 1.00  | 1.20 | 2.40    |
| 33                  | 1  | RECTANGLE | 1.00  | 1.90 | 1.90    |
| 34                  | 2  | RECTANGLE | 0.70  | 0.66 | 0.92    |
| 35                  | 2  | RECTANGLE | 0.70  | 1.20 | 1.68    |
| 36                  | 1  | RECTANGLE | 1.00  | 1.90 | 1.90    |
| 37                  | 1  | RECTANGLE | 2.27  | 0.75 | 1.70    |
| 39                  | 16 | RECTANGLE | 1.40  | 1.20 | 26.88   |
| 42                  | 2  | RECTANGLE | 0.80  | 1.20 | 1.92    |
| 43                  | 4  | RECTANGLE | 0.60  | 1.20 | 2.88    |
| 44                  | 1  | RECTANGLE | 49.10 | 0.30 | 14.73   |
| 45                  | 2  | RECTANGLE | 58.13 | 0.50 | 58.13   |
| 46                  | 1  | RECTANGLE | 7.35  | 0.73 | 5.37    |
| 47                  | 2  | RECTANGLE | 6.75  | 3.30 | 44.55   |
| 48                  | 23 | RECTANGLE | 1.80  | 0.60 | 24.84   |
| 49                  | 2  | RECTANGLE | 8.14  | 1.20 | 19.53   |
| 50                  | 2  | RECTANGLE | 8.33  | 1.20 | 19.99   |
| 51                  | 2  | RECTANGLE | 7.87  | 1.20 | 18.89   |
| 52                  | 2  | RECTANGLE | 8.86  | 1.20 | 21.26   |
| 53                  | 2  | RECTANGLE | 9.01  | 1.20 | 21.62   |
| 54                  | 2  | RECTANGLE | 8.99  | 1.20 | 21.57   |
| 55                  | 3  | RECTANGLE | 0.80  | 0.15 | 0.36    |
| 56                  | 3  | RECTANGLE | 1.20  | 5.20 | 18.72   |
| 57                  | 3  | RECTANGLE | 0.80  | 0.40 | 0.96    |
| 58                  | 2  | RECTANGLE | 1.20  | 5.75 | 13.80   |
| 59                  | 4  | RECTANGLE | 0.80  | 0.40 | 1.28    |
| 60                  | 1  | RECTANGLE | 7.48  | 1.20 | 8.98    |
| 61                  | 1  | RECTANGLE | 8.68  | 1.20 | 10.42   |
| 62                  | 2  | RECTANGLE | 7.92  | 1.20 | 19.01   |
| 63                  | 1  | RECTANGLE | 5.85  | 1.20 | 7.02    |
| 64                  | 1  | RECTANGLE | 5.03  | 1.20 | 6.04    |
| SUBTRACTION - T1    |    |           |       |      | 591.46  |
| R3                  | 1  | RECTANGLE | 2.10  | 6.12 | 12.85   |
| R4                  | 1  | RECTANGLE | 1.60  | 4.02 | 6.43    |
| R5                  | 1  | RECTANGLE | 6.77  | 5.02 | 33.99   |
| R6                  | 1  | RECTANGLE | 4.88  | 6.12 | 29.87   |
| R8                  | 1  | RECTANGLE | 1.71  | 6.32 | 10.78   |
| R9                  | 1  | RECTANGLE | 1.60  | 5.12 | 8.19    |
| R10                 | 1  | RECTANGLE | 3.10  | 1.00 | 3.10    |
| R11                 | 1  | RECTANGLE | 4.02  | 2.91 | 11.68   |
| R12                 | 1  | RECTANGLE | 3.51  | 6.12 | 21.46   |
| R13                 | 1  | RECTANGLE | 4.95  | 5.02 | 24.86   |
| SUBTRACTION - T2    |    |           |       |      | 163.20  |
| TOTAL - T1+T2       |    |           |       |      | 762.66  |
| TOTAL 6TH FLOOR FAR |    |           |       |      | 3114.39 |

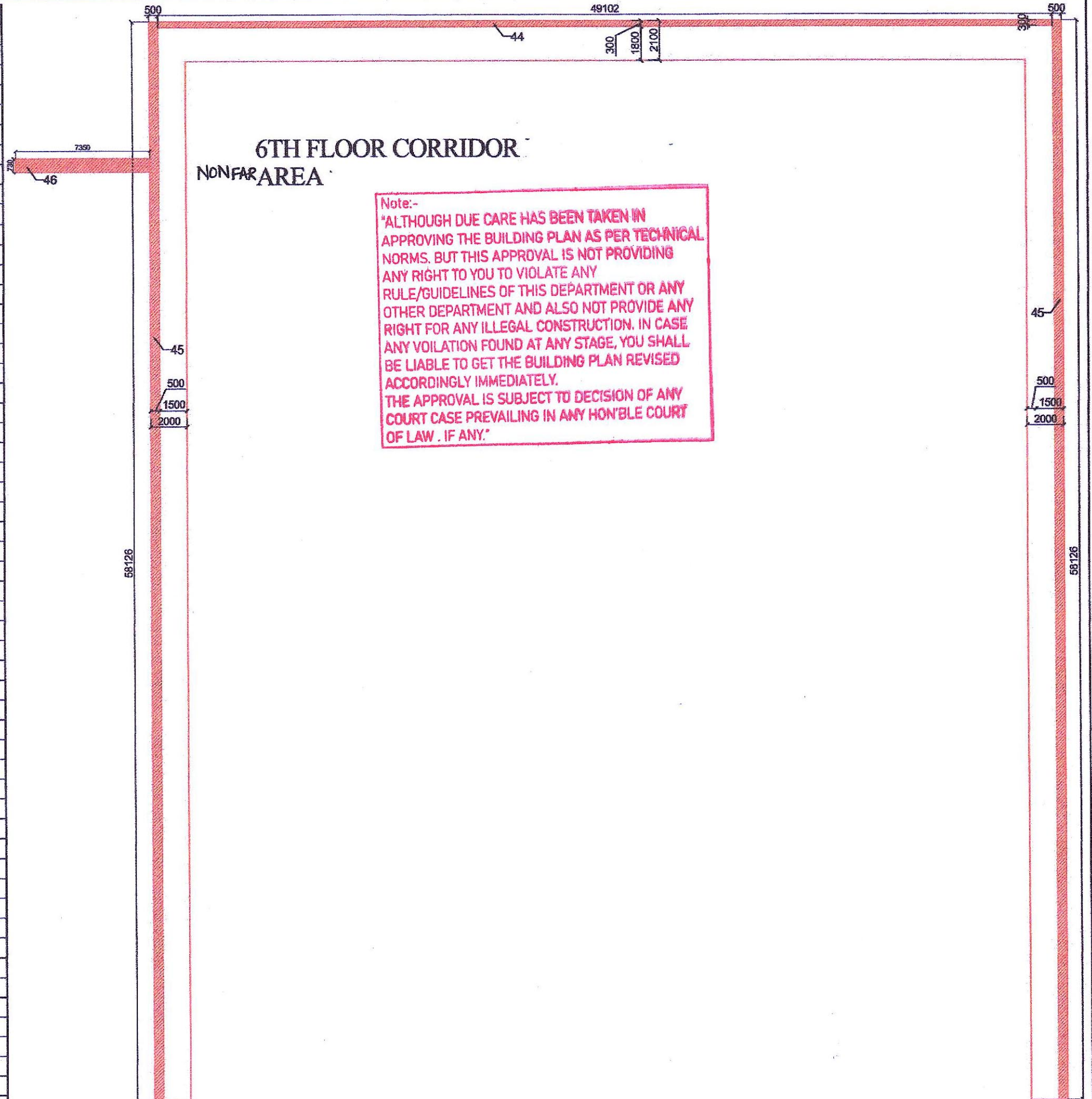

| REFUGE AREA DETAIL |      |           |      |       |        |
|--------------------|------|-----------|------|-------|--------|
| R1                 | 1.00 | RECTANGLE | 1.83 | 11.40 | 20.86  |
| R2                 | 1.00 | RECTANGLE | 1.46 | 11.20 | 16.35  |
| R3                 | 1.00 | RECTANGLE | 2.10 | 6.12  | 12.85  |
| R4                 | 1.00 | RECTANGLE | 1.60 | 4.02  | 6.43   |
| R5                 | 1.00 | RECTANGLE | 6.77 | 5.02  | 33.99  |
| R6                 | 1.00 | RECTANGLE | 4.88 | 6.12  | 29.87  |
| R7                 | 1.00 | RECTANGLE | 3.10 | 10.60 | 32.86  |
| R8                 | 1.00 | RECTANGLE | 1.71 | 6.32  | 10.78  |
| R9                 | 1.00 | RECTANGLE | 1.60 | 5.12  | 8.19   |
| R10                | 1.00 | RECTANGLE | 3.10 | 1.00  | 3.10   |
| R11                | 1.00 | RECTANGLE | 4.02 | 2.91  | 11.68  |
| R12                | 1.00 | RECTANGLE | 3.51 | 6.12  | 21.46  |
| R13                | 1.00 | RECTANGLE | 4.95 | 5.02  | 24.86  |
| TOTAL REFUGE AREA  |      |           |      |       | 233.27 |

| 6TH FLOOR AREA INCLUDING REFUSE AREA |                              |  |         |
|--------------------------------------|------------------------------|--|---------|
| 1                                    | FAR AREA + EXTRA REFUSE AREA |  | 3120.86 |
| 2                                    | NON FAR AREA + REFUSE AREA   |  | 826.28  |
| 3                                    | BUILT UP AREA + REFUSE AREA  |  | 3947.14 |

| REFUGE AREA DETAIL               |  | AREA IN SQ.M |
|----------------------------------|--|--------------|
| 6TH FLOOR BUILTUP AREA           |  | 3713.67      |
| 7TH FLOOR BUILTUP AREA           |  | 3713.23      |
| TOTAL BOTH FLOOR BUILTUP AREA    |  | 7426.90      |
| OCCUPANTS @ 10 SQM/PERSON        |  | 742.69       |
| SAY                              |  | 744.00       |
| .3 SQM REFUGE AREA/PERSON        |  | 223.20       |
| .9 SQM AREA @200 PERSONS (.9 X4) |  | 3.6          |
| TOTAL REFUGE AREA REQUIRED       |  | 226.80       |
| TOTAL REFUGE AREA PROVIDED       |  | 233.27       |
| EXTRA AREA TO BE CONSIDER IN FAR |  | 6.47         |

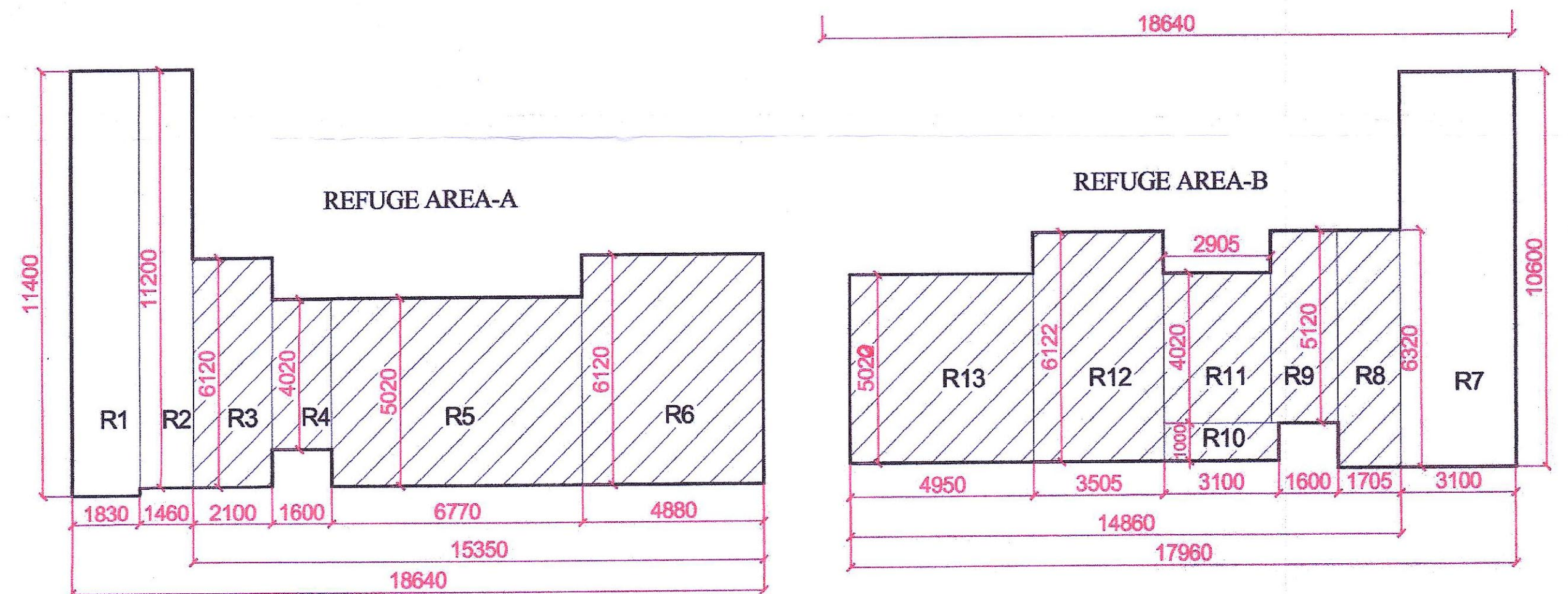

| 6TH FLOOR NON F.A.R. AREA |          |      |        |        |              |
|---------------------------|----------|------|--------|--------|--------------|
| S.N.O.                    | NO.      | TYPE | BREATH | LENGTH | AREA IN SQ.M |
| 1                         | TOTAL T1 |      |        |        | 591.46       |
| TOTAL NON FAR AREA        |          |      |        |        | 591.46       |
| TOTAL BUILTUP AREA        |          |      |        |        | 3713.67      |

THESE BUILDING PLANS ARE ISSUED  
VIDE LETTER NO. E0/GMADA/... DATED 14/8/25  
3794

Technically Approved  
(From Town Planning Point of View)  
Vide Letter No. ... DATED 02/01/2024  
DTP(S) ...

District Town Planner, S.A.S. Nagar.

Estate Officer (E)  
GMADA, S.A.S. Nagar

NOTE:  
1. BUILDING IS FULLY SPRINKLERS AND FULLY MECHANICALLY VENTILATED ARTIFICIALLY LIFTED WITH 100% POWER BACKUP AS PER NBC NORMS  
2. ALL RAILINGS ARE 1000MM IN HEIGHT.

CYBER SQUARE  
SITE NO 1 & SHOPPING COMPLEX  
PHASE -IX EXPANSION INDUSTRIAL  
FOCAL POINT SAS NAGAR MOHALI

OWNER'S SIGNATURE: [Signature]  
ARCHITECT'S SIGNATURE: [Signature]

DRAWING TITLE: SIXTH FLOOR FAR DETAIL SHEET  
DATE: 28.12.2024  
DRAWING NUMBER: A-20  
SCALE: 1:200

NAVNEET BARY  
CA NO. CA 0013495